

SLIDING, BI-FOLDING & STACKING

SLIDING SYSTEMS.....	4
BI-FOLDING SYSTEMS.....	26
STACKING SYSTEMS.....	30



CONTENTS		
SLIDING SYSTEMS		4-25
EWV.2SD EWV.4SD EWV.4DD EVC.2SD EVC.4SD EVC.4DD EVG.1SD EVG.12SD	VITRIS 120 SOFT CLOSE SLIDING DOOR KIT - WALL, CEILING AND GLASS MOUNTED	4
GPC2450 GPC2450.SS	PERLAN CEILING FIX KIT	6
GPW2450 GPW2450.SS	PERLAN WALL FIX KIT	7
GLC2450	LEVOLAN CEILING FIX KIT	8
GLW2450 GL602450	LEVOLAN WALL FIX KIT	9
PICO MS150 MS75 MS50	PICO SLIDING SYSTEM	10
GG.CW2000 GG.CW3000 GG.CW5000	GLASS GLIDE SLIDING DOOR KIT	12
GG.DK	GLASS GLIDE KIT FOR ADDITIONAL DOOR	12
GG.SP2000 GG.SP3000 GG.SP5000	GLASS GLIDE CEILING MOUNT WITH SIDELIGHT CARRIER KIT	13
GG.DK	GLASS GLIDE KIT FOR ADDITIONAL DOOR	13
RS10.2SD RS10.4SD RS10.4DD	EUROROLLER SLIDING SYSTEM KIT	14
RS10.R RS10.2T RS10.4T RS10.4DD	EUROROLLER COMPONENTS	14
ELBA	ELBA SLIDING SYSTEM	15
L100.1000 L100.1500 L100.2000	LINEAR 100 SLIDING DOOR KIT	16
L153.T40 L153.C50	LINEAR 100 COMPONENTS	16
L153.1000 L153.1500 L153.2000	LINEAR 153 SLIDING DOOR KIT	17
L153.T40 L153.C50	LINEAR 153 COMPONENTS	17

CONTENTS		
SLIDING SYSTEMS		4-25
PRAKTICA	PRAKTICA VARIANT SINGLE AND MULTIPLE SLIDING SYSTEM	18
MRS90.1250 MRS90.000 MRS90.L	SLIDING RAIL KIT METRO	18
MF250.1000 MF250.1500 MF250.2000	SLIDING DOOR KIT METRO	19
SS.1 SS.3R SS.3F	POINT FIX SLIDING SYSTEM	20
SS.4 SS.6 SS.7R SS.7FL SS.7FR SS.5	POINT FIX SLIDING SYSTEM	21
SSG10 SS.8 SS.9	POINT FIX SLIDING SYSTEM	22
RS150	FRAMELESS GLASS SLIDING DOOR CEILING FIX KIT - GCC	24
SM15 TM15	GCC FRAMELESS GLASS SLIDING DOOR COMPONENTS - GCC	24
TEC48 GR50 GR70	GCC FRAMELESS GLASS SLIDING DOOR COMPONENTS - GCC	25
BI-FOLDING SYSTEMS		26-29
SFW.DR.O	FRAMELESS GLASS FOLDING DOOR WITH DOOR RAILS - OFFSET ROLLER TYPE - GCC	26
SFW.DR.C	FRAMELESS GLASS FOLDING DOOR WITH DOOR RAILS - CENTRE ROLLER TYPE - GCC	27
BFS BFR	SLYDSTAK GLASS BI-FOLDING DOOR AUSTVISION	28
INVISIBLE	INVISIBLE CONNECTION - CASMA	29
STACKING SYSTEMS		30-32
SWS.DR	FRAMELESS GLASS STACKING DOOR WITH DOOR RAILS - GCC	30
SWS.PF	FRAMELESS GLASS STACKING DOOR WITH PATCH FITTING - GCC	31
FSR FSS	SLYDSTAK GLASS FOLDING STACKING DOOR AUSTVISION	32
JUNIOR	JUNIOR STACKING SYSTEM CASMA	32



ELITE GLASS SOLUTIONS

HEAD OFFICE
114 Endeavour Way
Sunshine West
VIC 3020 Australia

ADELAIDE OFFICE
7 Manfull Street
Melrose Park
SA 5039 Australia

1300 4 ELITE | 03 9314 6105
sales@eliteglassolutions.com.au
www.eliteglassolutions.com.au



SLIDING
SYSTEMS



VITRIS 120 SOFT CLOSE SLIDING DOOR KIT
WALL, CEILING AND GLASS MOUNTED

Item number	<p>Wall mounted</p> <ul style="list-style-type: none"> • EWV.2SD - single door 2 meter track • EWV.4SD - single door 4 meter track • EWV.4DD - double door 4 meter track <p>Ceiling mounted</p> <ul style="list-style-type: none"> • EVC.2SD - single door 2 meter track • EVC.4SD - single door 4 meter track • EVC.4DD - double door 4 meter track <p>Glass mounted</p> <ul style="list-style-type: none"> • EVG.1SD - single door threshold opening 1 meter • EVG.12SD - single door threshold opening 1.2 meter
Description	<ul style="list-style-type: none"> • VITRIS soft close sliding door • maximum door weight 120kg • easy installation and no glass cutout required • comfort stop - prevents door from banging, eliminates the associated noise and vibration • removes risk of trapped fingers • modular construction means it can be adapted to customer requirements • kit includes <ul style="list-style-type: none"> – 1 x soft close mechanism – 1 x track – end caps and cover – wheel assembly kit – door stops – floor guide • available with softstop close action maximum door weight 80kg
Suitable for	<ul style="list-style-type: none"> • 8mm, 10mm and 12mm toughened glass thickness • 8.76mm, 10.76mm and 12.76mm toughened laminated glass thickness • ceiling, wall-fixed installation or to a glass overlite
Material finish	<ul style="list-style-type: none"> • satin anodised aluminium



**ELITE GLASS
SOLUTIONS**

HEAD OFFICE
114 Endeavour Way
Sunshine West
VIC 3020 Australia

ADELAIDE OFFICE
7 Manfull Street
Melrose Park
SA 5039 Australia

1300 4 ELITE | 03 9314 6105
sales@eliteglassolutions.com.au
www.eliteglassolutions.com.au

VITRIS 120 DETERMINATION OF GLASS HEIGHT AND WIDTH

Glass height	$H = R - 43\text{mm}$
Glass width	$A = LW + 70\text{mm}$ (single door) $A = LW/2 + 33\text{mm}$ (double door)

VITRIS 120 KEY

A =	glass width of sliding sash
H1 /H2=	glass height of sliding/fixed sash
LH =	clear height
LW =	clear width (opening)
R =	room height



EVW, EVC, EVG

WALL MOUNTED

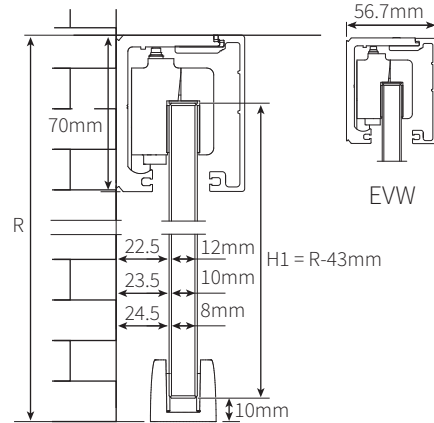

CEILING MOUNTED

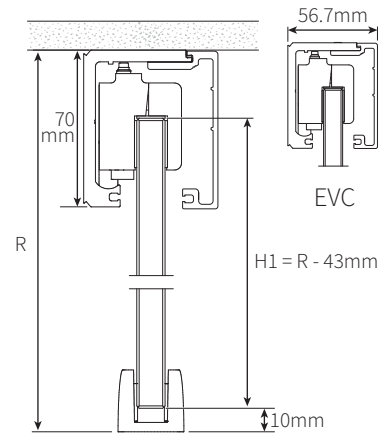

GLASS MOUNTED

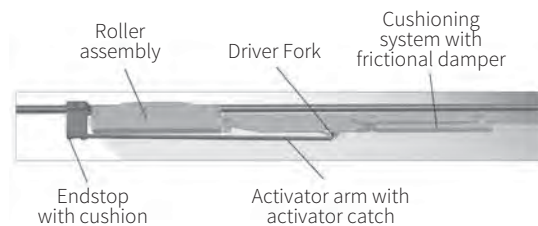
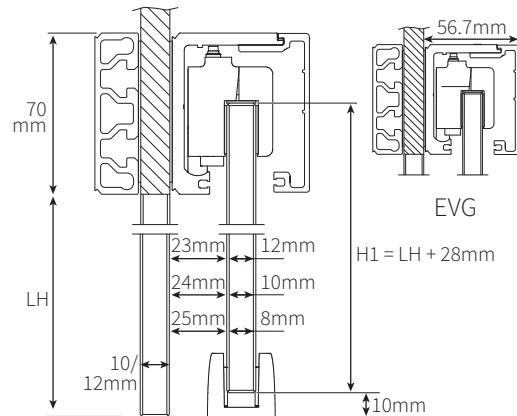

ELITE GLASS SOLUTIONS

HEAD OFFICE
114 Endeavour Way
Sunshine West
VIC 3020 Australia

ADELAIDE OFFICE
7 Manfull Street
Melrose Park
SA 5039 Australia

1300 4 ELITE | 03 9314 6105
sales@eliteglassolutions.com.au
www.eliteglassolutions.com.au

PERLAN CEILING FIX KIT

Item number	<ul style="list-style-type: none"> • GPC2450 • GPC2450.SS - softstop
Description	<ul style="list-style-type: none"> • perlan ceiling fix kit • maximum door weight 140kg • kit includes <ul style="list-style-type: none"> – 1 x 2.45 meter track – 2 x double roller carriages – 2 x black plastic track end caps – 2 x tube buffers – 1 x hold open spring – 2 x glass clamping plates with individual covers and black plastic end caps – 1 x adjustable glass floorguide – please note no handle included • available with softstop close action maximum door weight 80kg • no glass cut out required
Suitable for	<ul style="list-style-type: none"> • 8mm, 10mm and 12mm glass thickness • ceiling mounting
Material finish	<ul style="list-style-type: none"> • anodised stainless steel

GPC2450

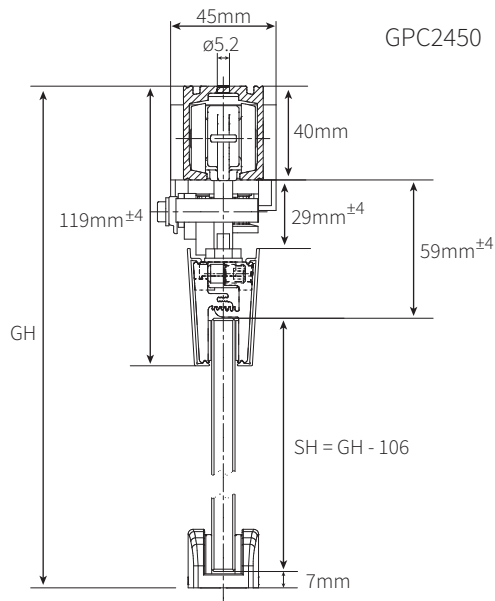

NO GLASS CUT OUT REQUIRED



HEAD OFFICE
114 Endeavour Way
Sunshine West
VIC 3020 Australia

ADELAIDE OFFICE
7 Manfull Street
Melrose Park
SA 5039 Australia

1300 4 ELITE | 03 9314 6105
sales@eliteglassolutions.com.au
www.eliteglassolutions.com.au

PERLAN WALL FIX KIT

Item number	<ul style="list-style-type: none"> • GPW2450 • GPW2450.SS - softstop
Description	<ul style="list-style-type: none"> • perlan wall fix kit • maximum door weight 140kg • kit includes <ul style="list-style-type: none"> – 1 x 2.45 meter track – 1 x concealed wall bracket – 2 x end caps for concealed wall bracket and track – 2 x double roller carriages – 2 x tube buffers – 1 x hold open spring – 2 x glass clamping plates with individual covers and black plastic end caps – 1 x adjustable glass floorguide – please note no handle included • available with softstop close action maximum door weight 80kg
Suitable for	<ul style="list-style-type: none"> • 8mm, 10mm and 12mm glass thickness • wall mounting
Material finish	<ul style="list-style-type: none"> • anodised stainless steel

GPW2450

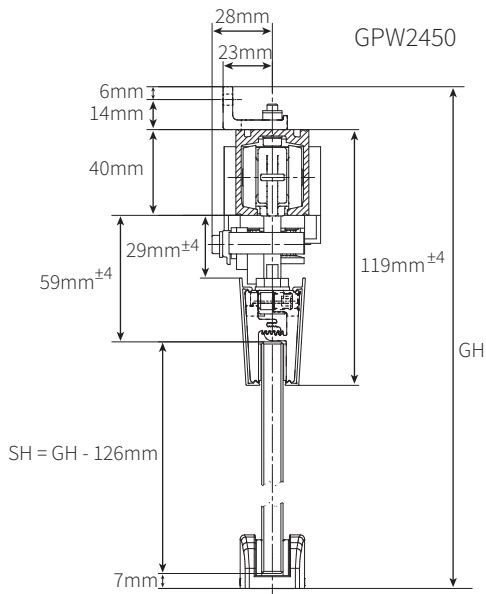

ELITE GLASS SOLUTIONS

HEAD OFFICE
114 Endeavour Way
Sunshine West
VIC 3020 Australia

ADELAIDE OFFICE
7 Manfull Street
Melrose Park
SA 5039 Australia

1300 4 ELITE | 03 9314 6105
sales@eliteglassolutions.com.au
www.eliteglassolutions.com.au

LEVOLAN CEILING FIX KIT

Item number	GLC2450
Description	<ul style="list-style-type: none"> • levolan ceiling fix kit • maximum door weight 150kg • kit includes <ul style="list-style-type: none"> – 1 x 2.45 meter track and cover profile – 2 x roller carriages – 2 x buffers – 2 x end covers – 1 x brush seal – 1 x adjustable floorguide – please note no handle included • available with softstop close action maximum door weight 80kg • no glass cut out required
Suitable for	<ul style="list-style-type: none"> • 8mm, 10mm and 12mm glass thickness • ceiling mounting
Material finish	• anodised stainless steel

GLC2450

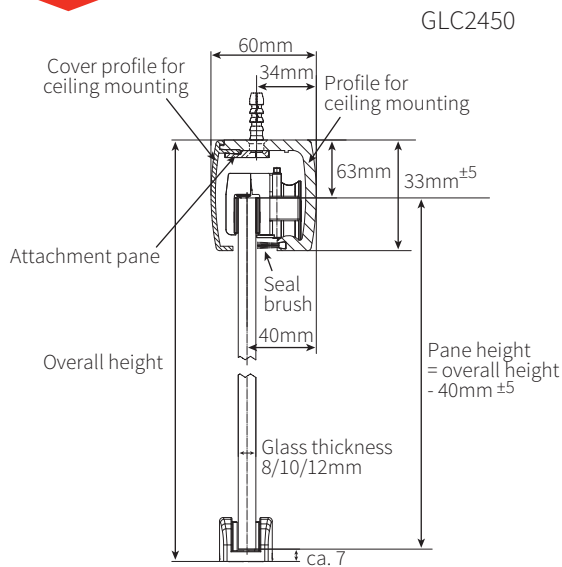

NO GLASS CUT OUT REQUIRED



ELITE GLASS SOLUTIONS

HEAD OFFICE
114 Endeavour Way
Sunshine West
VIC 3020 Australia

ADELAIDE OFFICE
7 Manfull Street
Melrose Park
SA 5039 Australia

1300 4 ELITE | 03 9314 6105
sales@eliteglassolutions.com.au
www.eliteglassolutions.com.au

LEVOLAN WALL FIX KIT

Item number	<ul style="list-style-type: none"> GLW2450 maximum door weight 1,500kg GL602450 maximum door weight 60kg
Description	<ul style="list-style-type: none"> levolan wall fix kit kit includes <ul style="list-style-type: none"> - 1 x 2.45 meter track and wall bracket profile - 2 x roller carriages - 2 x buffers - 2 x end covers - 1 x brush seal - 1 x adjustable floorguide - please note no handle included • available with softstop close action maximum door weight 80kg • no glass cut out required
Suitable for	<ul style="list-style-type: none"> • 8mm, 10mm and 12mm glass thickness • wall mounting
Material finish	• anodised stainless steel



GLW2450
GL602450

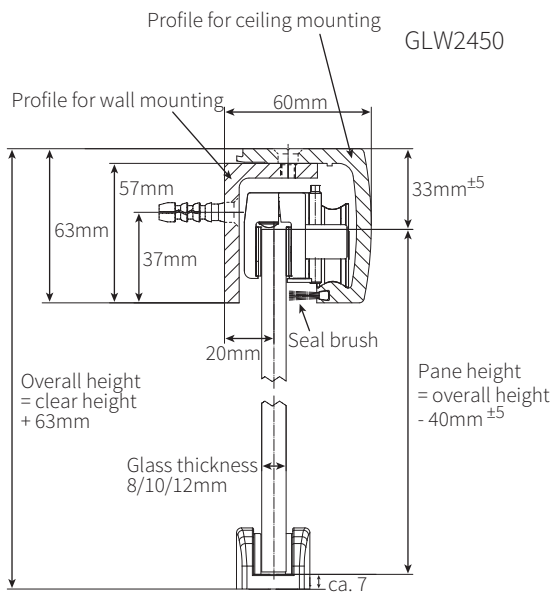

NO GLASS CUT OUT REQUIRED



ELITE GLASS SOLUTIONS

HEAD OFFICE
114 Endeavour Way
Sunshine West
VIC 3020 Australia

ADELAIDE OFFICE
7 Manfull Street
Melrose Park
SA 5039 Australia

1300 4 ELITE | 03 9314 6105
sales@eliteglassolutions.com.au
www.eliteglassolutions.com.au

PICO SLIDING SYSTEM

Description

- one of our smallest sliding door system PICO runs with enormous precision, as the upper track is reduced to a minimum special rollers guarantee for smooth sliding at all times. With the three weight options a suitable system is available for every application. The maintenance-free units allow for a gentle and quiet movement of the sliding panels. By means of the integrated height-adjusting mechanisms the panels can be easily adjusted. The upper tracks can be fixed to walls as well as ceilings which allows for a great flexibility in design.
- one or two panel sliding door system with/without fix panel



PICO SLIDING SYSTEM
MAXIMUM WEIGHT PER PANEL 150KG

Item number	MS150
Description	<ul style="list-style-type: none"> • PICO sliding system maximum weight per panel 150kg • maximum dimensions 1.5 meters x 3 meters • minimum width of panel 500mm • kit includes <ul style="list-style-type: none"> – two trolleys, length 160mm each – two limit stop buffers – one bottom floor guide
Suitable for	• 8mm, 10mm and 12mm glass thickness
Material finish	• two different kinds of upper tracks are available in anodised aluminium in various colours: with or without side fixed panels

MS150



DETAIL GLASS PREPARATION

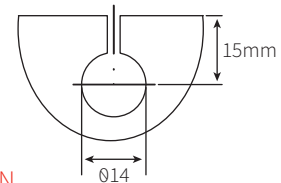

GLASS PREPARATION

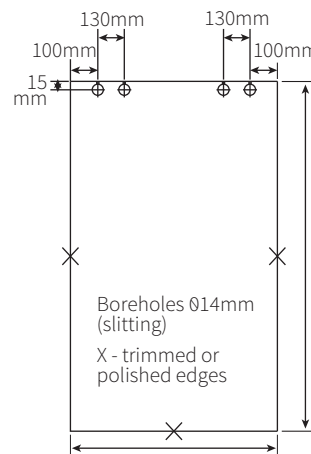

ELITE GLASS SOLUTIONS

HEAD OFFICE
114 Endeavour Way
Sunshine West
VIC 3020 Australia

ADELAIDE OFFICE
7 Manfull Street
Melrose Park
SA 5039 Australia

1300 4 ELITE | 03 9314 6105
sales@eliteglassolutions.com.au
www.eliteglassolutions.com.au

PICO SLIDING SYSTEM
MAXIMUM WEIGHT PER PANEL 75KG

Item number	MS75
Description	<ul style="list-style-type: none"> • PICO sliding system maximum weight per panel 75kg • maximum dimensions 1.2 meters x 2.5 meters • minimum width of panel 380mm • kit includes <ul style="list-style-type: none"> – two trolleys, length 115mm each – two limit stop buffers – one bottom floor guide
Suitable for	• 8mm and 10mm glass thickness
Material finish	• two different kinds of upper tracks are available in anodised aluminium in various colours: with or without side fixed panels

PICO SLIDING SYSTEM
MAXIMUM WEIGHT PER PANEL 50KG

Item number	MS50
Description	<ul style="list-style-type: none"> • PICO sliding system maximum weight per panel 50kg • maximum dimensions 1.0 meter x 2 meters • minimum width of panel 250mm • kit includes <ul style="list-style-type: none"> – two trolleys, length 60mm each – two limit stop buffers – one bottom floor guide
Suitable for	• 8mm and 10mm glass thickness
Material finish	• two different kinds of upper tracks are available in anodised aluminium in various colours: with or without side fixed panels

MS75



DETAIL GLASS PREPARATION

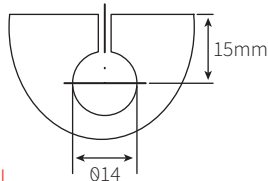

GLASS PREPARATION

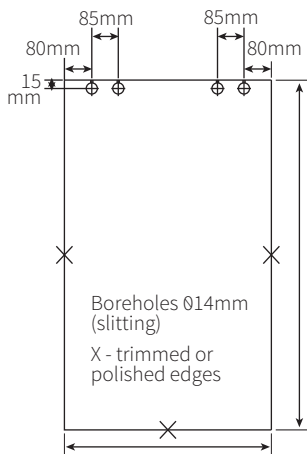

MS50



DETAIL GLASS PREPARATION

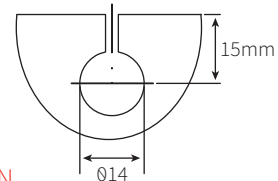

GLASS PREPARATION

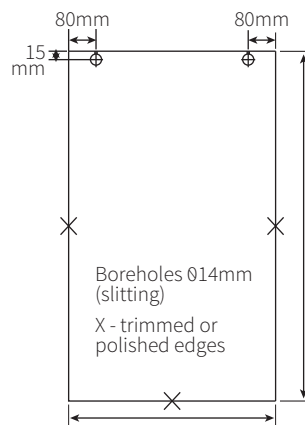

ELITE GLASS SOLUTIONS

HEAD OFFICE
114 Endeavour Way
Sunshine West
VIC 3020 Australia

ADELAIDE OFFICE
7 Manfull Street
Melrose Park
SA 5039 Australia

1300 4 ELITE | 03 9314 6105
sales@eliteglassolutions.com.au
www.eliteglassolutions.com.au

GLASS GLIDE SLIDING DOOR KIT

Item number	<ul style="list-style-type: none"> GG.CW2000 - suitable for door up to 1 meter wide GG.CW3000 - suitable for door up to 1.5 meter wide GG.CW5000 - suitable for door up to 2.5 meters wide
Description	<ul style="list-style-type: none"> glass glide sliding door kit maximum door weight 150kg slim profile track top hung system no glass cutout required kit includes <ul style="list-style-type: none"> – track – pelmet – hangers – stops – end caps – floor guides
Suitable for	<ul style="list-style-type: none"> 8mm, 10mm and 12mm glass thickness ceiling or wall fix installations
Material finish	<ul style="list-style-type: none"> natural anodized finish

GLASS GLIDE KIT FOR ADDITIONAL DOOR

Item number	GG.DK
Description	<ul style="list-style-type: none"> glass glide kit for additional door kit includes <ul style="list-style-type: none"> – hangers, stops and floor guides

TO DETERMINE DOOR HEIGHT AND WIDTH

Door height Wall Mounted	<p>TH = Opening height to underside of transom</p> <p>DH = Glass door height</p> <p>DH = TH plus 25mm</p>
Door height Ceiling Mounted	<p>H = Overall opening height</p> <p>DH = Glass door height</p> <p>DH = H less 37mm</p>
Door width	<p>COW = Clear opening width</p> <p>DW = Door width</p> <p>Doors typically overlap the clear opening by 35mm each side</p> <p>Eg. DW = COW + 70mm</p> <p>Track length is 2 x door width</p>

GG.CW

WALL MOUNTED

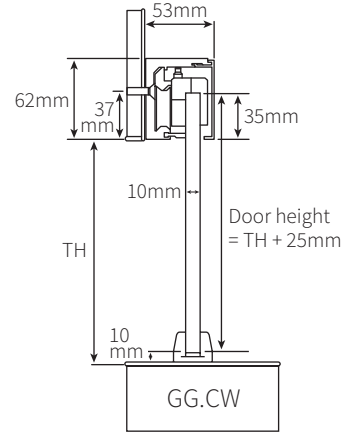

CEILING MOUNTED

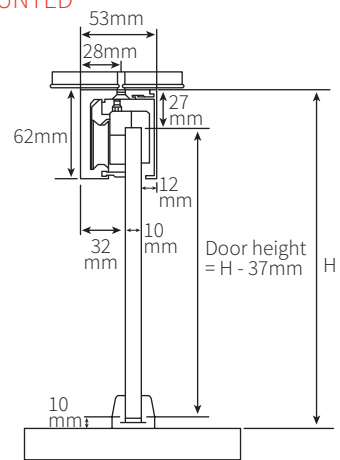

TO DETERMINE DOOR WIDTH

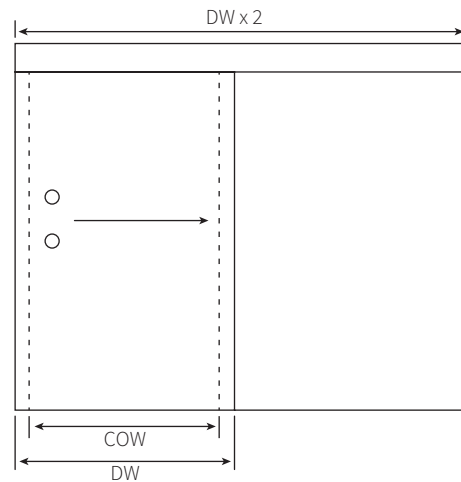

ELITE GLASS SOLUTIONS

HEAD OFFICE
114 Endeavour Way
Sunshine West
VIC 3020 Australia

ADELAIDE OFFICE
7 Manfull Street
Melrose Park
SA 5039 Australia

1300 4 ELITE | 03 9314 6105
sales@eliteglassolutions.com.au
www.eliteglassolutions.com.au

GLASS GLIDE CEILING MOUNT WITH SIDELIGHT CARRIER KIT

Item number	<ul style="list-style-type: none"> • GG.SP2000 - door set to suit opening up to 2 meters wide • GG.SP3000 - door set to suit opening up to 3 meters wide • GG.SP5000 - door set to suit opening up to 5 meters wide
Description	<ul style="list-style-type: none"> • glass glide ceiling mount with sidelight carrier • maximum door weight 150kg • slim profile track with sidelight • carrier section • top hung system • no glass cutout required • kit includes <ul style="list-style-type: none"> – track – sidelight carrier section – infill channel for carrier – hangers – stops – end caps – floor guides
Suitable for	<ul style="list-style-type: none"> • 8mm, 10mm and 12mm glass thickness • ceiling fix
Material finish	<ul style="list-style-type: none"> • natural anodized finish

GLASS GLIDE KIT FOR ADDITIONAL DOOR

Item number	GG.DK
Description	<ul style="list-style-type: none"> • glass glide kit for additional door • kit includes <ul style="list-style-type: none"> – hangers, stops and floor guides

TO DETERMINE THE HEIGHT OF GLASS DOORS AND SIDELIGHTS

Height	<p>H = Overall opening height DH = Glass door height DH = H less 37mm SL = Glass sidelight height SL = H less 47mm</p>
---------------	--

With the Glass Glide sliding door and sidelight system there are numerous set out options. To the right are two of the more common options.

Note: It is recommended that the door and sidelight overlap be 35mm each side. When glazing side lights specify CS25 channel.

GG.SP

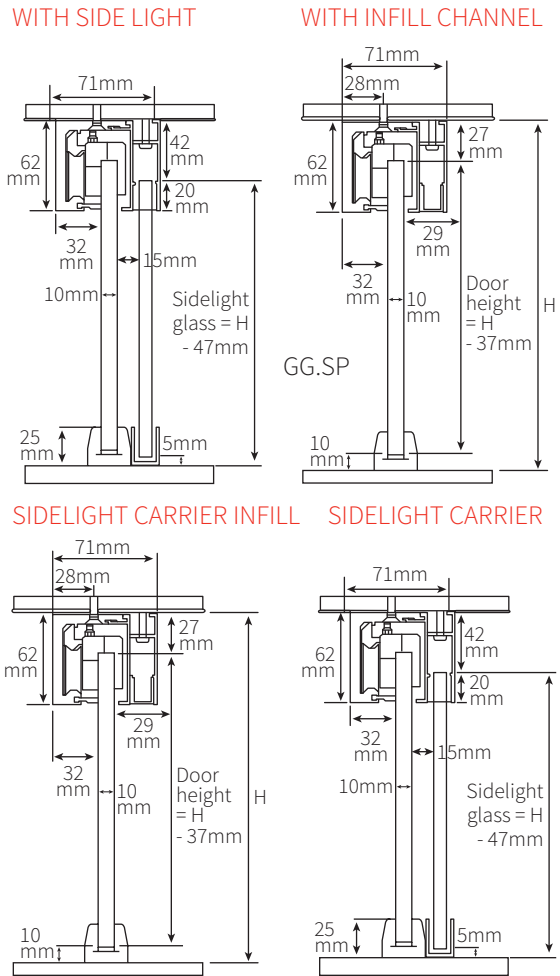

TO DETERMINE THE HEIGHT OF GLASS DOORS & SIDELIGHTS

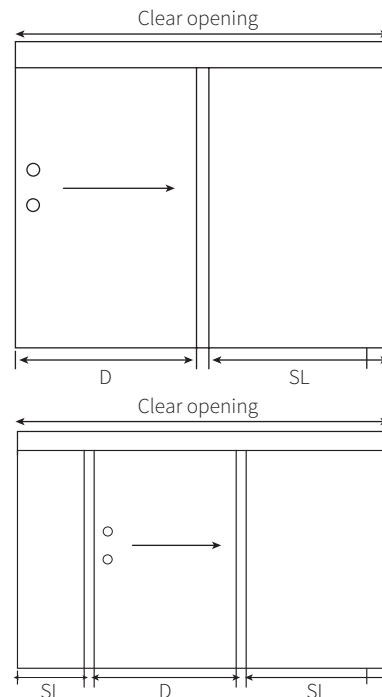

ELITE GLASS SOLUTIONS

HEAD OFFICE
 114 Endeavour Way
 Sunshine West
 VIC 3020 Australia

ADELAIDE OFFICE
 7 Manfull Street
 Melrose Park
 SA 5039 Australia

1300 4 ELITE | 03 9314 6105
 sales@eliteglassolutions.com.au
 www.eliteglassolutions.com.au

EUROROLLER SLIDING SYSTEM KIT

Item number	<ul style="list-style-type: none"> • RS10.2SD - includes 2 meter track for single door • RS10.4SD - includes 4 meter track for single door • RS10.4DD - includes 4 meter track for double door
Description	<ul style="list-style-type: none"> • euroroller sliding system • kit includes <ul style="list-style-type: none"> – bottom track – rollers and stops – felt brush seal (for channel) – COM1 top channel guide – 2 x COM3 end caps • maximum load 150kg per door, two rollers and two stops supplied per door
Suitable for	<ul style="list-style-type: none"> • 10mm and 12mm glass thickness
Material finish	<ul style="list-style-type: none"> • polished or satin stainless steel - rollers • satin stainless steel - track

EUROROLLER COMPONENTS

Item number	<ul style="list-style-type: none"> • RS10.R - roller • RS10.2T - 2 meter track • RS10.4T - 4 meter track • RS10.4DD - double door 4 meter track
Description	<ul style="list-style-type: none"> • euroroller components • maximum load per roller 75kg
Suitable for	<ul style="list-style-type: none"> • euroroller systems



RS10

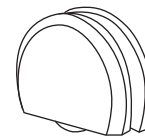
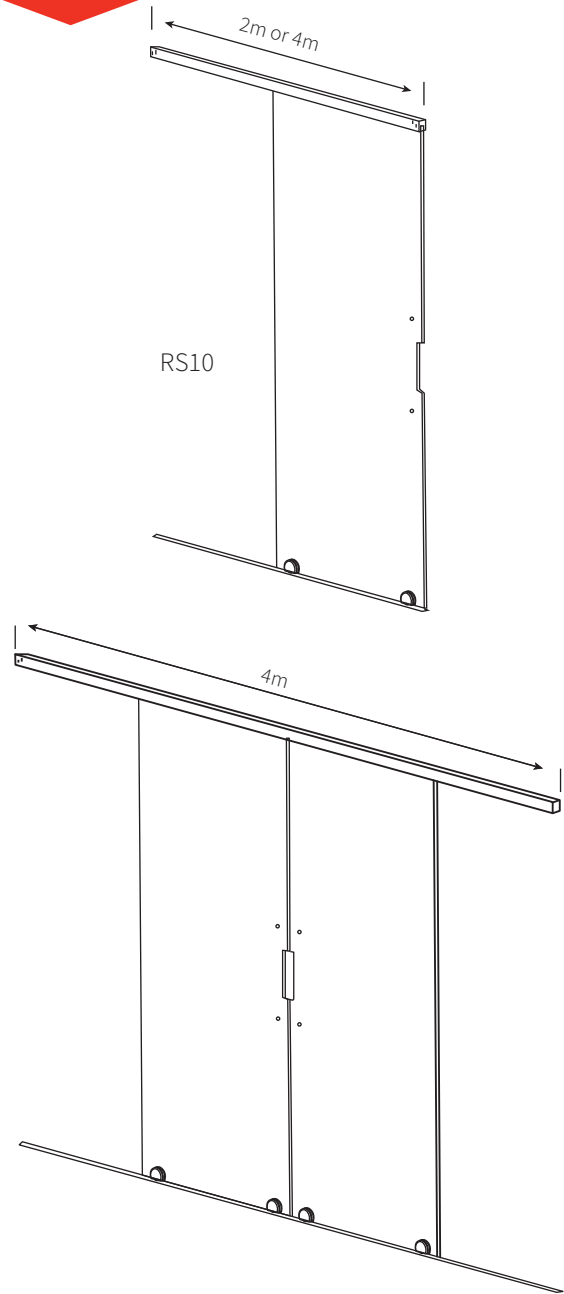

RS10.R

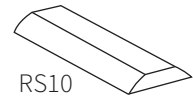

RS10

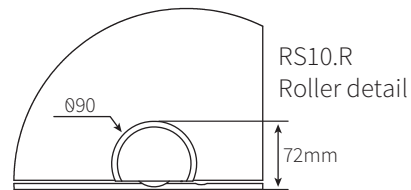

RS10.R
Roller detail



ELITE GLASS SOLUTIONS

HEAD OFFICE
114 Endeavour Way
Sunshine West
VIC 3020 Australia

ADELAIDE OFFICE
7 Manfull Street
Melrose Park
SA 5039 Australia

1300 4 ELITE | 03 9314 6105
sales@eliteglassolutions.com.au
www.eliteglassolutions.com.au

RS10

GLASS DETAIL

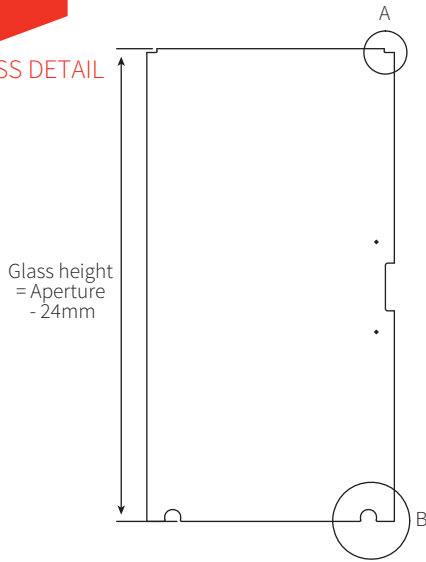

ROLLER - GLASS CUTOUT DETAIL

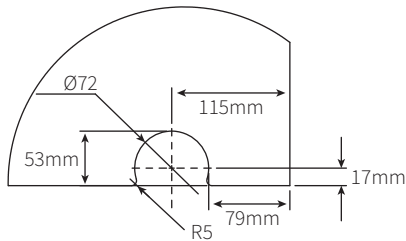

STOP - GLASS CUTOUT DETAIL

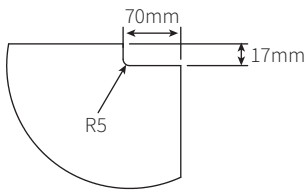

RS10 CROSS SECTION DETAIL

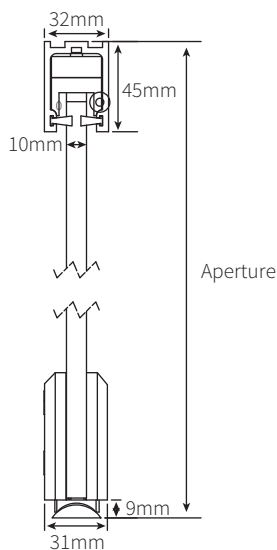

ELBA SLIDING SYSTEM

Item number	ELBA
Description	<ul style="list-style-type: none"> • elba sliding system • maximum wing weight 100kg • born as an alternative solution to the numberless so-called “naked” sliding systems, featuring point fixed solution to the glass • its upper track is made of two parallel steel rods kept together by rounded clamps, used to reinforce and fix the two rods and the whole system to the walls or glass panels • glass panel require two cut outs • sliding door dimensions vary according to the distance between the fixing points <p>Download the ELBA flyer from our website for further information</p>
Suitable for	• 8mm, 10mm and 12mm glass thickness
Material finish	• stainless steel



ELITE GLASS SOLUTIONS

HEAD OFFICE
114 Endeavour Way
Sunshine West
VIC 3020 Australia

ADELAIDE OFFICE
7 Manfull Street
Melrose Park
SA 5039 Australia

1300 4 ELITE | 03 9314 6105
sales@eliteglassolutions.com.au
www.eliteglassolutions.com.au

LINEAR 100 SLIDING DOOR KIT

Item number	<ul style="list-style-type: none"> L100.1000 - suitable for one door up to 1 meter wide track and channel 2 meters L100.1500 - suitable for one door up to 1.5 meter wide track and channel 3 meters L100.2000 - suitable for one door up to 2 meters wide track and channel 4 meters
Description	<ul style="list-style-type: none"> linear 100 sliding door kit maximum door weight 170kg bottom rolling sliding door system kit includes <ul style="list-style-type: none"> - 2 x 100 wheels - 2 x top channel stops - 2 x top channel - 1 x bottom channel
Suitable for	<ul style="list-style-type: none"> 10mm and 12mm glass thickness floor and ceiling fix installations
Material finish	<ul style="list-style-type: none"> satin stainless steel (wheels) natural anodised (channels) aluminium (floor track)

L100

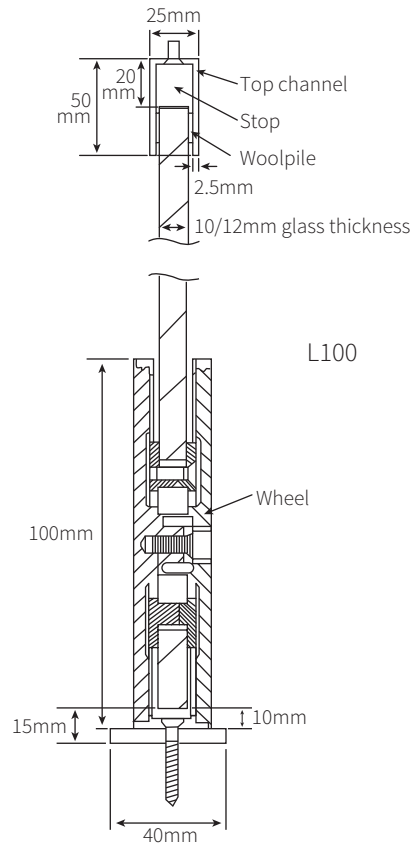

LINEAR 100 COMPONENTS

Item number	<ul style="list-style-type: none"> L153.T40 - bottom track L153.C50 - top channel
Description	<ul style="list-style-type: none"> linear 100 components side mount channel fittings available on request system can be used with multiple lines of track for several doors opening in the same direction and biparting applications
Suitable for	<ul style="list-style-type: none"> linear 100 systems

TYPICAL GLASS SET OUT

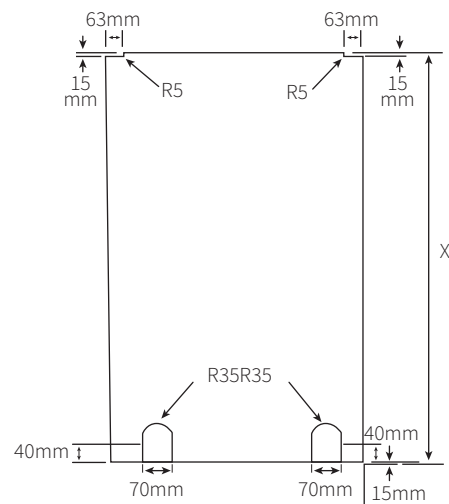

KEY

X =	height of door which is finished opening height less 35mm
T =	glass thickness

Note: Allow for selected handle glass preparation.



HEAD OFFICE
114 Endeavour Way
Sunshine West
VIC 3020 Australia

ADELAIDE OFFICE
7 Manfull Street
Melrose Park
SA 5039 Australia

1300 4 ELITE | 03 9314 6105
sales@eliteglassolutions.com.au
www.eliteglassolutions.com.au

LINEAR 153 SLIDING DOOR KIT

Item number	<ul style="list-style-type: none"> L153.1000 - suitable for one door up to 1 meter wide track and channel 2 meters L153.1500 - suitable for one door up to 1.5 meter wide track and channel 3 meters L153.2000 - suitable for one door up to 2 meters wide track and channel 4 meters
Description	<ul style="list-style-type: none"> linear 153 sliding door kit maximum door weight 250kg bottom rolling sliding door system kit includes <ul style="list-style-type: none"> – 2 x 153 wheels – 2 x top channel stops – 2 x top channel – 1 x bottom channel system can be used with multiple lines of track for several doors opening in the same direction and biparting applications
Suitable for	<ul style="list-style-type: none"> 10mm and 12mm glass thickness
Material finish	<ul style="list-style-type: none"> satin stainless steel (wheels) natural anodised (channels) aluminium (floor track)

L153

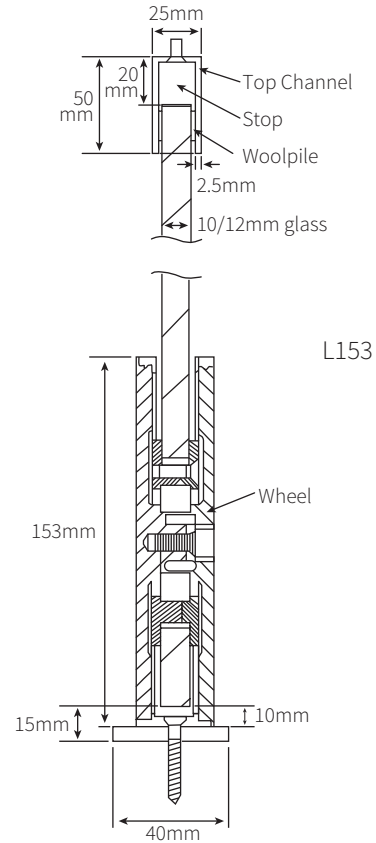

LINEAR 153 COMPONENTS

Item number	<ul style="list-style-type: none"> L153.T40 - bottom track L153.C50 - top channel
Description	<ul style="list-style-type: none"> linear 153 components side mount channel fittings available on request
Suitable for	<ul style="list-style-type: none"> linear 153 systems

KEY

X =	height of door which is finished opening height less 35mm
T =	glass thickness

Note: Allow for selected handle glass preparation.

TYPICAL GLASS SET OUT

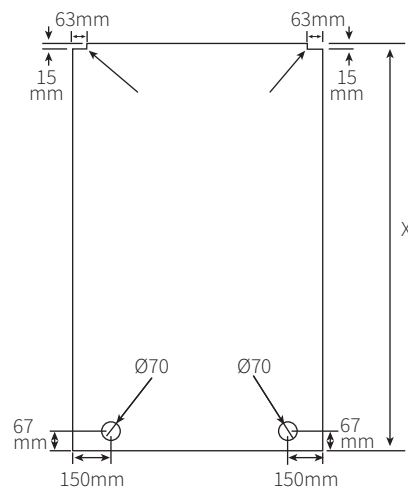

ELITE GLASS SOLUTIONS

HEAD OFFICE
114 Endeavour Way
Sunshine West
VIC 3020 Australia

ADELAIDE OFFICE
7 Manfull Street
Melrose Park
SA 5039 Australia

1300 4 ELITE | 03 9314 6105
sales@eliteglassolutions.com.au
www.eliteglassolutions.com.au

PRAKTIKA VARIANT SINGLE AND MULTIPLE SLIDING SYSTEM

Item number	PRAKTIKA
Description	<ul style="list-style-type: none"> • Praktika variant single and multiple sliding system • maximum wing weight 90kg • minimum wing width 680mm • hanging fittings and rollers are concealed inside the upper track, thus giving the opening a “total glass” look even with fixed side panels, as the upper track features a special groove for them. • kit includes <ul style="list-style-type: none"> – 2 x hanging fittings 280mm wide – one floor guiding patch <p>Download the Praktika flyer from our website for further information</p>
Suitable for	• 8mm, 10mm and 12mm glass thickness
Material finish	• silver anodised aluminium or painted aluminium in different colours (upper track)



SLIDING RAIL KIT METRO

Item number	<ul style="list-style-type: none"> • MRS90.1250 - suitable to slide one door up to 1.25 meters wide • MRS90.000 - custom door kit can be designed with multiple lines of track for several doors opening in the same direction and bi-parting applications • MRS90.L - bottom lock with keeper
Description	<ul style="list-style-type: none"> • sliding rail kit - metro • maximum door weight 180kg • bottom rail sliding system • kit includes <ul style="list-style-type: none"> – bottom sliding rail – bottom track – top channel – 2 x channel stops
Suitable for	• 10mm and 12mm glass thickness
Material finish	• natural anodised

MRS90

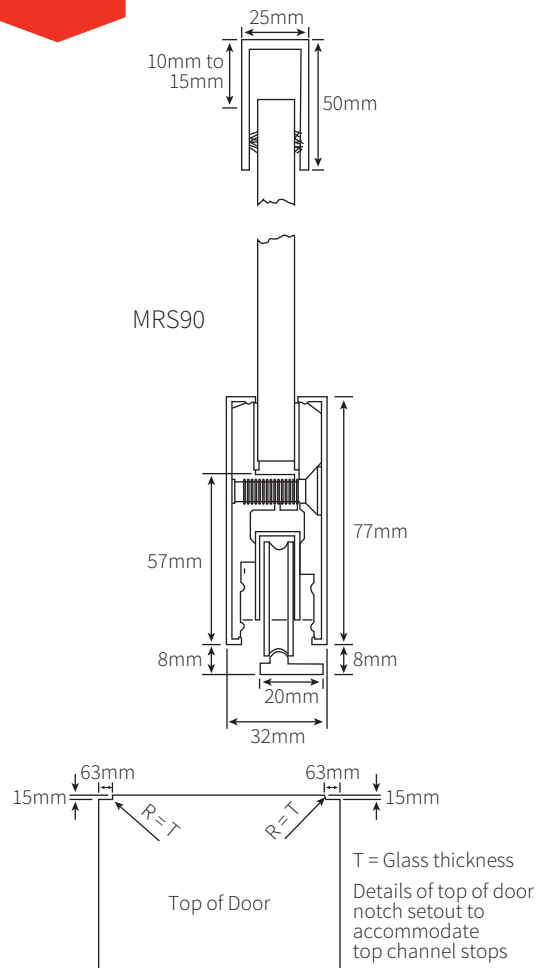

ELITE GLASS SOLUTIONS

HEAD OFFICE
114 Endeavour Way
Sunshine West
VIC 3020 Australia

ADELAIDE OFFICE
7 Manfull Street
Melrose Park
SA 5039 Australia

1300 4 ELITE | 03 9314 6105
sales@eliteglassolutions.com.au
www.eliteglassolutions.com.au

SLIDING DOOR KIT METRO

Item number	<ul style="list-style-type: none"> MF250.1000 - suitable for one door up to 1 meter wide track 2 meters MF250.1500 - suitable for one door up to 1.5 meter wide track 3 meters MF250.2000 - suitable for one door up to 2 meters wide track 4 meters
Description	<ul style="list-style-type: none"> sliding door kit - metro maximum door weight 250kg top hung system with standard top rail no cutout in glass required kit includes <ul style="list-style-type: none"> 1 x top track 1 x top rail 2 x hangers 2 x track steps 1 x floor guide system can be used in single, biparting and multiple lines of sliding doors bottom rails and in ground channel guide systems available on request
Suitable for	<ul style="list-style-type: none"> 10mm and 12mm glass thickness
Material finish	<ul style="list-style-type: none"> natural anodised (track and rail)

METRO MF250 COMPONENTS

Item number	<ul style="list-style-type: none"> MF250.2000 - custom door set MF250.T50 - additional track per meter
Description	<ul style="list-style-type: none"> metro MF250 components
Suitable for	<ul style="list-style-type: none"> metro MF250 systems

MF250

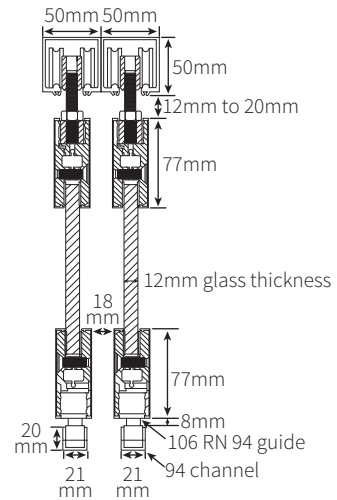
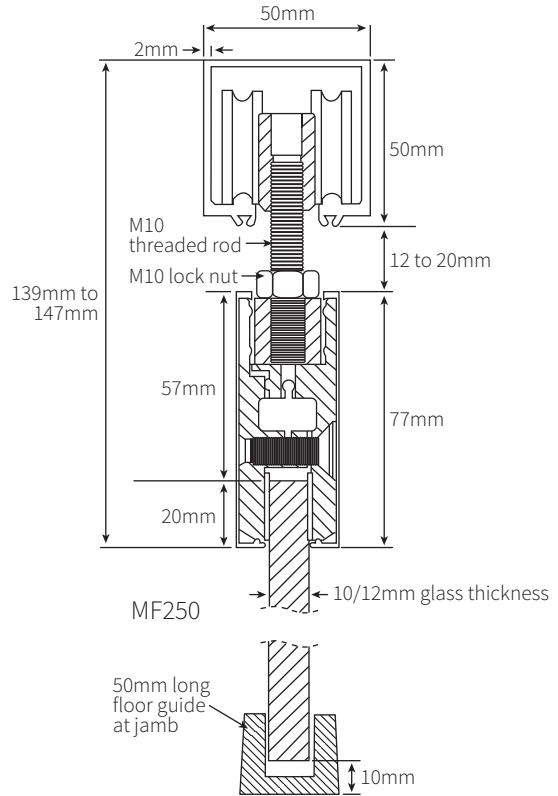

ELITE GLASS SOLUTIONS

HEAD OFFICE
114 Endeavour Way
Sunshine West
VIC 3020 Australia

ADELAIDE OFFICE
7 Manfull Street
Melrose Park
SA 5039 Australia

1300 4 ELITE | 03 9314 6105
sales@eliteglassolutions.com.au
www.eliteglassolutions.com.au

POINT FIX SLIDING SYSTEM



SS

GLASS DETAIL

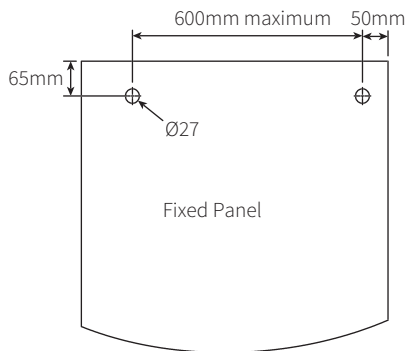
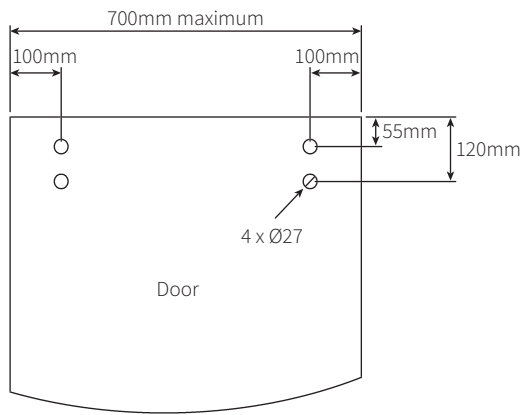

POINT FIX SLIDING SYSTEM TUBE TOP RAIL

Item number	SS.1
Description	<ul style="list-style-type: none"> point fix sliding system tube top rail cut to size per 1 meter, includes two ends caps
Material finish	<ul style="list-style-type: none"> satin stainless steel

SS.1

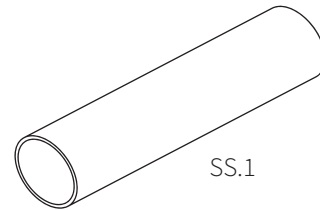

POINT FIX SLIDING SYSTEM GLASS HANGER BAR

Item number	<ul style="list-style-type: none"> SS.3R - round bar SS.3F - flat bar
Description	<ul style="list-style-type: none"> point fix sliding system glass hanger bar two required per door
Suitable for	<ul style="list-style-type: none"> adjusting to suit 10mm and 12mm glass thickness
Material finish	<ul style="list-style-type: none"> satin stainless steel

SS.3R
SS.3F

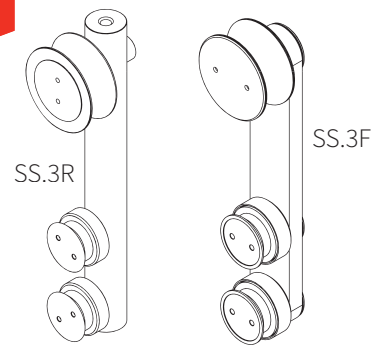

ELITE GLASS SOLUTIONS

HEAD OFFICE
114 Endeavour Way
Sunshine West
VIC 3020 Australia

ADELAIDE OFFICE
7 Manfull Street
Melrose Park
SA 5039 Australia

1300 4 ELITE | 03 9314 6105
sales@eliteglassolutions.com.au
www.eliteglassolutions.com.au

POINT FIX SLIDING SYSTEM WALL ANCHOR

Item number	SS.4
Description	• point fix sliding system wall anchor
Suitable for	• SS.1 tube top rail
Material finish	• satin stainless steel

SS.4

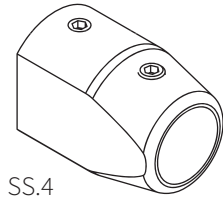

SS.4

POINT FIX SLIDING SYSTEM STOP

Item number	• SS.7R - round with spring stop • SS.7FL - flat stop - left hand • SS.7FR - flat stop - right hand
Description	• point fix sliding system stop
Material finish	• satin stainless steel

SS.7R

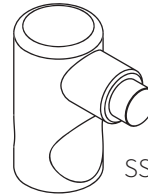

SS.7R

POINT FIX SLIDING SYSTEM GLASS MOUNT CLAMP

Item number	SS.5
Description	• point fix sliding system glass mount clamp
Material finish	• satin stainless steel

SS.5

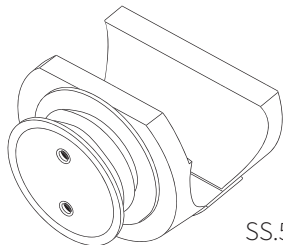

SS.5

SS.7FL
SS.7FR



SS.7FL
SS.7FR

POINT FIX SLIDING SYSTEM WALL MOUNT CLAMP

Item number	SS.6
Description	• point fix sliding system wall mount clamp
Material finish	• satin stainless steel

SS.6

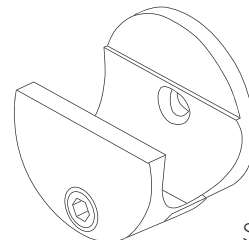

SS.6



ELITE GLASS SOLUTIONS

HEAD OFFICE
114 Endeavour Way
Sunshine West
VIC 3020 Australia

ADELAIDE OFFICE
7 Manfull Street
Melrose Park
SA 5039 Australia

1300 4 ELITE | 03 9314 6105
sales@eliteglassolutions.com.au
www.eliteglassolutions.com.au

POINT FIX SLIDING SYSTEM FLOOR GUIDE

Item number	SS.G10
Description	<ul style="list-style-type: none"> • point fix sliding system floor guide • clips on to the channel • no fixings required
Suitable for	• 10mm glass thickness
Material finish	• satin stainless steel

SS.G10

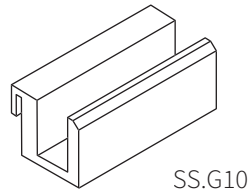

POINT FIX SLIDING SYSTEM
SLIDING DOOR FINGER PULL

Item number	SS.9
Description	<ul style="list-style-type: none"> • point fix sliding system sliding door finger pull • glass hole size 48mm • 58mm overall diameter
Suitable for	• 8mm and 10mm glass thickness
Material finish	• satin stainless steel

SS.9

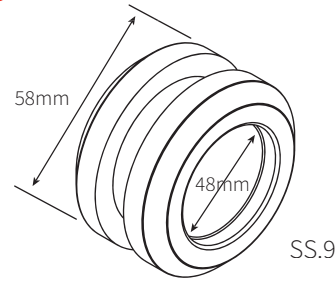

POINT FIX SLIDING SYSTEM FLOOR GUIDE

Item number	SS.8
Description	<ul style="list-style-type: none"> • point fix sliding system floor guide • base thickness is 6mm
Suitable for	• adjusting to suit 8mm, 10mm and 12mm glass thickness
Material finish	• satin stainless steel

SS.8

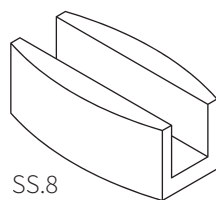

GLASS CUT OUT DETAIL

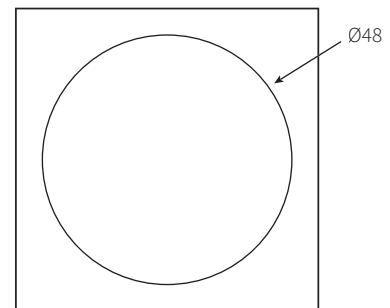

ELITE GLASS SOLUTIONS

HEAD OFFICE
114 Endeavour Way
Sunshine West
VIC 3020 Australia

ADELAIDE OFFICE
7 Manfull Street
Melrose Park
SA 5039 Australia

1300 4 ELITE | 03 9314 6105
sales@eliteglassolutions.com.au
www.eliteglassolutions.com.au



FRAMELESS GLASS SLIDING DOOR
CEILING FIX KIT - GCC

Item number	RS150
Description	<ul style="list-style-type: none"> • frameless glass sliding door system - ceiling fix kit - GCC • maximum door weight 150kg • kit includes: <ul style="list-style-type: none"> – 1 x 3 meters sliding door track – 2 x roller carriages – 2 x end stop and holder – 1 x 1.5 meter top sliding door rail non-locking – 2 x 1.5 meters brush door seals – 1 x bottom guider roller – 1 x glass or door rail bottom guide – please note no handle included
Suitable for	• 10mm and 12mm glass thickness

RS150

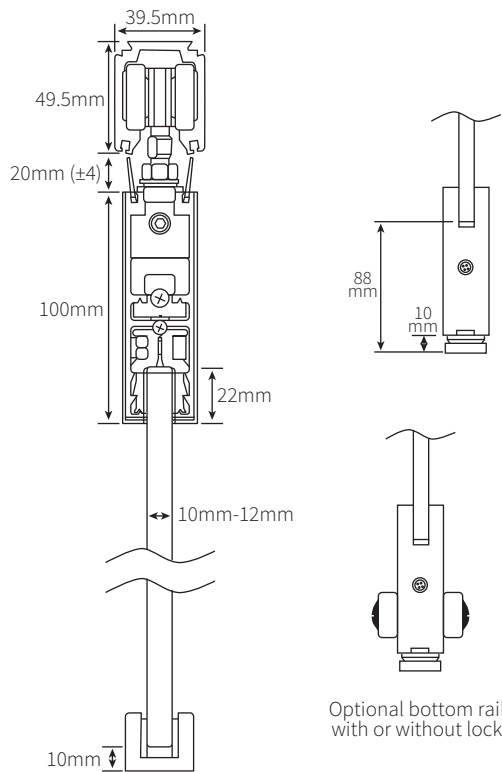

RS150

GCC FRAMELESS GLASS SLIDING DOOR
SIDE MOUNT BRACKET - GCC

Item number	SM15
Description	• GCC frameless glass sliding door side mount bracket

SM15

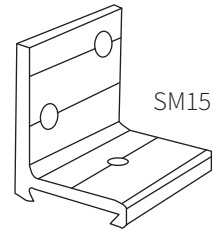

GCC FRAMELESS GLASS SLIDING DOOR
TOP MOUNT BRACKET - GCC

Item number	TM15
Description	• GCC frameless glass sliding door top mount bracket

TM15

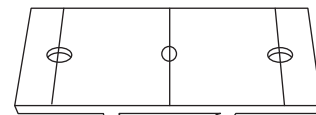

TM15



ELITE GLASS SOLUTIONS

HEAD OFFICE
114 Endeavour Way
Sunshine West
VIC 3020 Australia

ADELAIDE OFFICE
7 Manfull Street
Melrose Park
SA 5039 Australia

1300 4 ELITE | 03 9314 6105
sales@eliteglassolutions.com.au
www.eliteglassolutions.com.au

GCC FRAMELESS GLASS SLIDING DOOR
END CAP - GCC

Item number	TEC48
Description	• GCC frameless glass sliding door end cap

TEC48

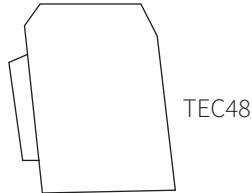

GCC FRAMELESS GLASS SLIDING DOOR
BOTTOM SLIDING DOOR RAIL - GCC

Item number	• GR50 - non-locking • GR70 - locking
Description	• GCC frameless glass sliding door 1.5 meters bottom sliding door rail

GR50
GR70

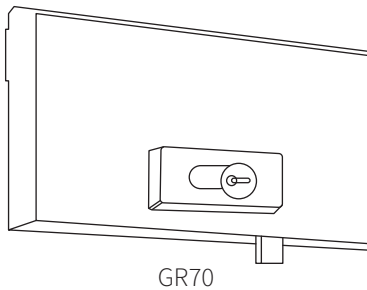

ELITE GLASS SOLUTIONS

HEAD OFFICE
114 Endeavour Way
Sunshine West
VIC 3020 Australia

ADELAIDE OFFICE
7 Manfull Street
Melrose Park
SA 5039 Australia

1300 4 ELITE | 03 9314 6105
sales@eliteglassolutions.com.au
www.eliteglassolutions.com.au

BI-FOLDING SYSTEMS



FRAMELESS GLASS FOLDING DOOR WITH DOOR RAILS - OFFSET ROLLER TYPE - GCC

Item number	SFW.DR.O
Description	<ul style="list-style-type: none"> • frameless glass folding door system with door rails - GCC • offset roller type • custom designed • maximum panel height 3 meters • maximum panel width 850mm • maximum panel weight 80kg
Suitable for	• 10mm and 12mm glass thickness
Material finish	• natural anodised

SFW.DR.O

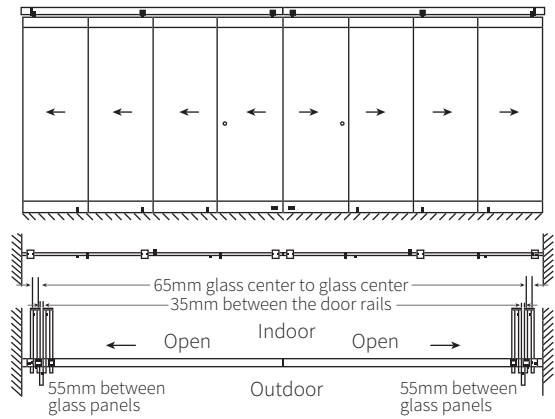

SFW.DR.O



ELITE GLASS SOLUTIONS

HEAD OFFICE
114 Endeavour Way
Sunshine West
VIC 3020 Australia

ADELAIDE OFFICE
7 Manfull Street
Melrose Park
SA 5039 Australia

1300 4 ELITE | 03 9314 6105
sales@eliteglassolutions.com.au
www.eliteglassolutions.com.au

FRAMELESS GLASS FOLDING DOOR WITH DOOR RAILS - CENTRE ROLLER TYPE - GCC

Item number	SFW.DR.C
Description	<ul style="list-style-type: none"> • frameless glass folding door system with door rails - GCC • centre roller type • custom designed • maximum panel height 3 meters • maximum panel width 1 meter • maximum panel weight 80kg
Suitable for	• 10mm and 12mm glass thickness
Material finish	• natural anodised

SFW.DR.C

GCC®

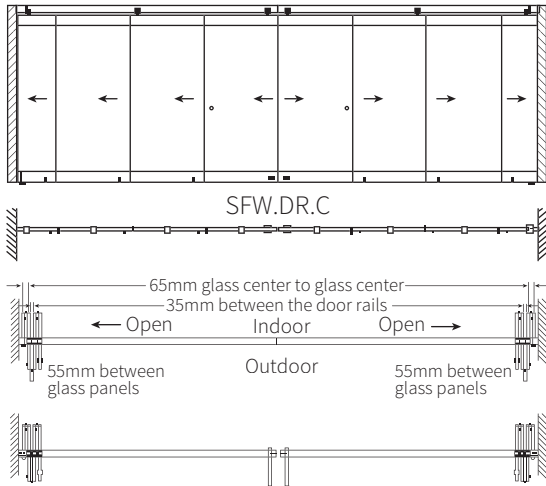

SFW.DR.C

GCC®

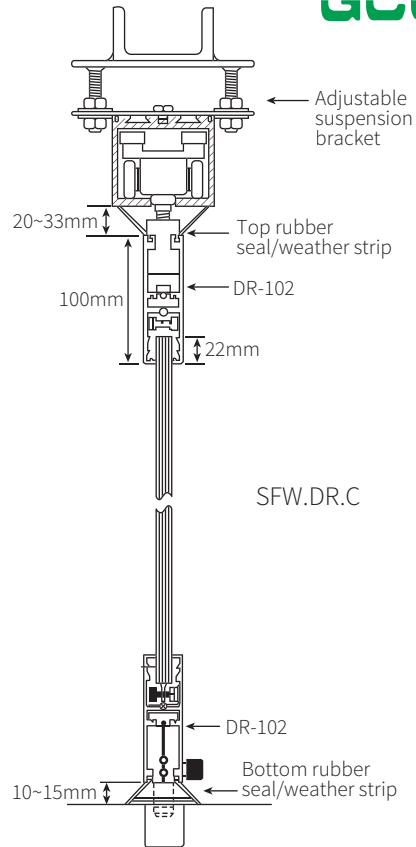

ELITE GLASS SOLUTIONS

HEAD OFFICE
114 Endeavour Way
Sunshine West
VIC 3020 Australia

ADELAIDE OFFICE
7 Manfull Street
Melrose Park
SA 5039 Australia

1300 4 ELITE | 03 9314 6105
sales@eliteglassolutions.com.au
www.eliteglassolutions.com.au

SLYDSTAK GLASS BI-FOLDING DOOR
AUSTVISION

Item number	<ul style="list-style-type: none"> • BFS - top spider hanger and bottom patch lock • BFR - top and bottom door rail
Description	<ul style="list-style-type: none"> • Slydstak glass bi-folding door - AUSTVISION • heavy duty top track extrusion • hidden fixing system • smooth nylon radial suspension roller system • rollers rated to 110kg each (typically two per door) • good corrosion resistance • special track covers to support ceiling panels • range of hardware options • easy to measure, install and maintain
Suitable for	<ul style="list-style-type: none"> • 10mm, 12mm and 15mm glass thickness • steel, concrete or timber
Material finish	<ul style="list-style-type: none"> • extruded aluminium in natural anodised aluminium finish (overhead track) • extruded aluminium standard in 316 stainless steel cover, 25 micron natural anodised aluminium and powder coated (door rails) • natural anodised aluminium finish or powder coated (cover plates for the overhead track) • 316 grade polished or satin stainless steel (spider hangers and patch locks)

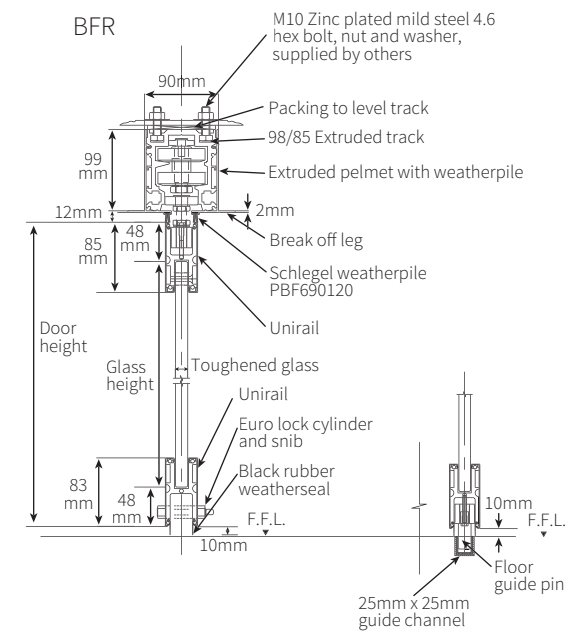
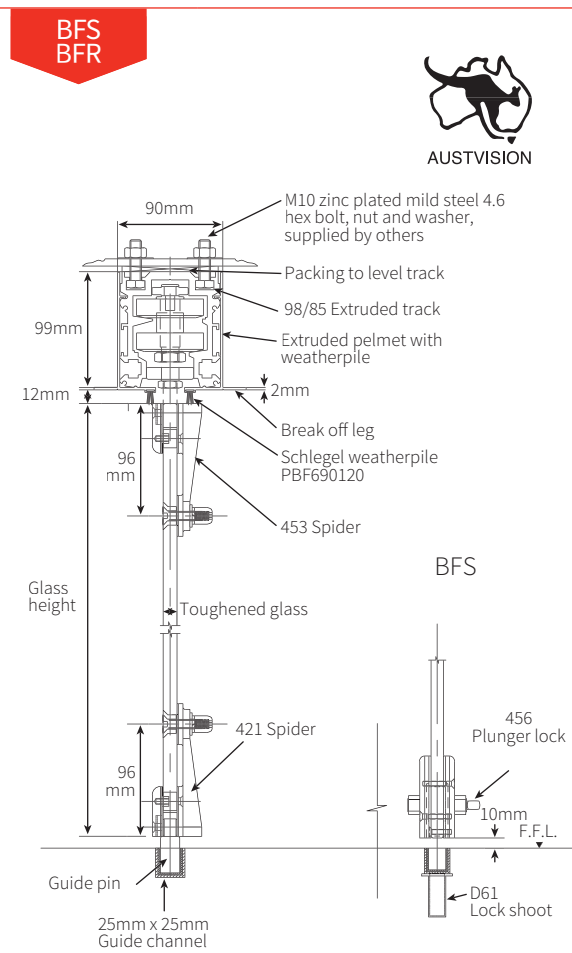

HEAD OFFICE
114 Endeavour Way
Sunshine West
VIC 3020 Australia

ADELAIDE OFFICE
7 Manfull Street
Melrose Park
SA 5039 Australia

1300 4 ELITE | 03 9314 6105
sales@eliteglassolutions.com.au
www.eliteglassolutions.com.au

INVISIBLE CONNECTION - CASMA

Item number	Invisible
Description	<ul style="list-style-type: none"> invisible connection - CASMA an innovative hardware system for frameless glass-folding doors exclusively equipped with patch fittings the system hangs and slides in a top-mounted track and the wings are aligned in a „U” brass profile hidden in the floor maximum size of each wing is 900mm x 3 meters x 10mm maximum number of wings is 10 for a total opening of 900mm e.g. 6 wings on each side <p>Download the Invisible flyer from our website for further information</p>
Suitable for	<ul style="list-style-type: none"> 8mm and 10mm glass thickness steel, concrete or timber
Material finish	<ul style="list-style-type: none"> aluminium



ELITE GLASS SOLUTIONS

HEAD OFFICE
114 Endeavour Way
Sunshine West
VIC 3020 Australia

ADELAIDE OFFICE
7 Manfull Street
Melrose Park
SA 5039 Australia

☎ 1300 4 ELITE | 03 9314 6105
✉ sales@eliteglassolutions.com.au
🌐 www.eliteglassolutions.com.au



STACKING
SYSTEMS

FRAMELESS GLASS STACKING DOOR
WITH DOOR RAILS - GCC

Item number	SWS.DR
Description	<ul style="list-style-type: none"> • frameless glass stacking door with door rails - GCC • custom designed • maximum panel height 4 meters • maximum panel width 1.25 meters • maximum panel weight 150kg
Suitable for	<ul style="list-style-type: none"> • 10mm, 12mm and 15mm glass thickness
Material finish	<ul style="list-style-type: none"> • natural anodised

SWS.DR

GCC®

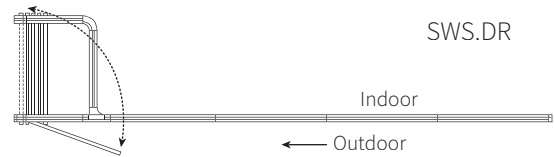
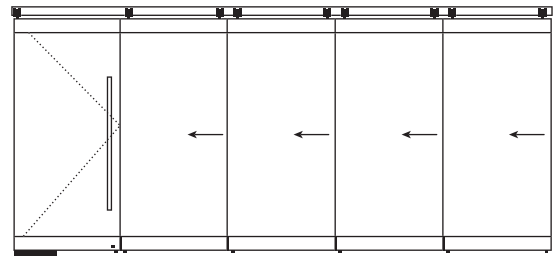

**ELITE GLASS
SOLUTIONS**

HEAD OFFICE
114 Endeavour Way
Sunshine West
VIC 3020 Australia

ADELAIDE OFFICE
7 Manfull Street
Melrose Park
SA 5039 Australia

1300 4 ELITE | 03 9314 6105
sales@eliteglassolutions.com.au
www.eliteglassolutions.com.au

SWS.DR
SWS.PF

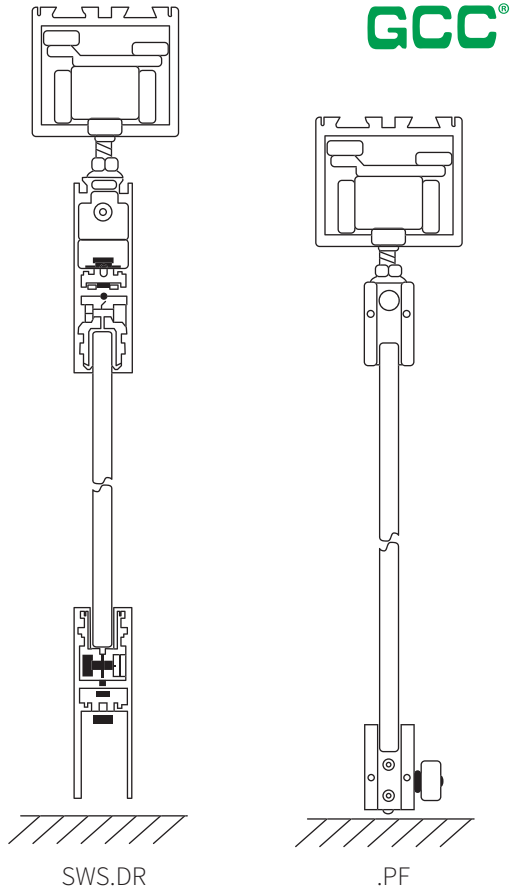

FRAMELESS GLASS STACKING DOOR
WITH PATCH FITTING - GCC

Item number	SWS.PF
Description	<ul style="list-style-type: none"> • frameless glass stacking door with patch fitting - GCC • custom designed • maximum panel height 3 meters • maximum panel width 1 meter • maximum panel weight 85kg <p>Download flyer from our website for set out and fixing details</p>
Suitable for	• 10mm, 12mm and 15mm glass thickness
Material finish	• polished or satin stainless steel

SWS.PF

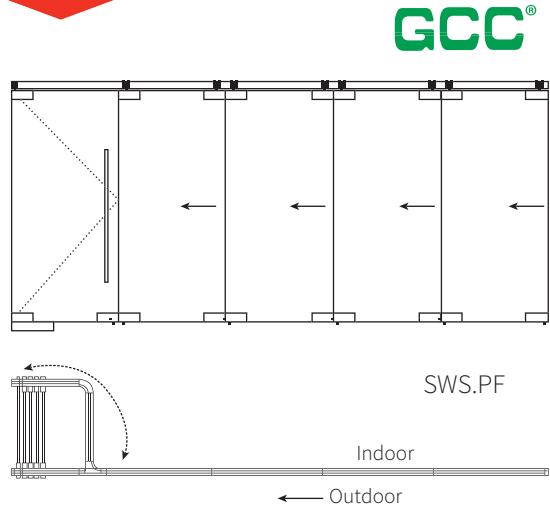

ELITE GLASS SOLUTIONS

HEAD OFFICE
114 Endeavour Way
Sunshine West
VIC 3020 Australia

ADELAIDE OFFICE
7 Manfull Street
Melrose Park
SA 5039 Australia

1300 4 ELITE | 03 9314 6105
sales@eliteglassolutions.com.au
www.eliteglassolutions.com.au

SLYDSTAK GLASS FOLDING STACKING DOOR
AUSTVISION

Item number	<ul style="list-style-type: none"> • FSR - top and/or bottom door rail with locking and latching • FSS - top spider hanger and bottom patch lock
Description	<ul style="list-style-type: none"> • Slydstak glass folding stacking door - AUSTVISION • heavy duty top track extrusion • hidden fixing system • smooth nylon radial suspension roller system • rollers rated to 110kg each (typically two per door) • good corrosion resistance • a range of parking bag options to stack doors • special track covers to support ceiling panels • range of hardware options • easy to measure, install and maintain
Suitable for	<ul style="list-style-type: none"> • 10mm, 12mm and 15mm glass thickness • steel, concrete and timber
Material finish	<ul style="list-style-type: none"> • extruded aluminium in natural anodised aluminium finish (overhead track) • extruded aluminium standard in 316 stainless steel cover, 25 micron natural anodised aluminium and powder coated (door rails) • natural anodised aluminium finish or powder coated (cover plates for the overhead track) • 316 grade polished or satin stainless steel (spider hangers and patch locks)



JUNIOR STACKING SYSTEM
CASMA

Item number	Junior
Description	<ul style="list-style-type: none"> • Junior stacking system - CASMA • maximum wing dimensions 1 meter W x 3 meters H • maximum wing weight 80kg • the independent wing system slides inside a top mounted track • the wings can be stacked away in specifically designed parking bays, which can be either parallel or perpendicular to the sliding track • the system allows an unlimited number of wings and segmented installations, with very low bending radius • thanks to the use of patch fittings system with small interchangeable covers, extremely light glass surfaces can be created <p>Download the Junior flyer from our website for further information</p>
Suitable for	<ul style="list-style-type: none"> • 8mm, 10mm and 12mm glass thickness
Material finish	<ul style="list-style-type: none"> • aluminium and stainless steel



ELITE GLASS SOLUTIONS

HEAD OFFICE
114 Endeavour Way
Sunshine West
VIC 3020 Australia

ADELAIDE OFFICE
7 Manfull Street
Melrose Park
SA 5039 Australia

1300 4 ELITE | 03 9314 6105
sales@eliteglassolutions.com.au
www.eliteglassolutions.com.au